

An aerial photograph of Philadelphia, showing the city skyline in the background and the Community College of Philadelphia campus in the foreground. The campus features several large, modern buildings with flat roofs and some older, more classical structures. The city skyline includes various skyscrapers and buildings, with the Sun Tower being a prominent feature. The overall scene is captured from a high angle, providing a comprehensive view of the urban landscape.

Community College *of* Philadelphia

FACILITIES MASTER PLAN

November, 2016

DRAFT

FACILITIES MASTER PLAN

November 2016

1. Plan Framework
2. Programming Summary
3. Master Plan Recommendations
4. Phasing: Landscape & Public Realm Strategy
5. Regional Centers

A low-angle, upward-looking photograph of a modern building's exterior. The image shows a complex arrangement of glass panels, metal frames, and perforated metal walkways or balconies. The building's architecture is characterized by sharp angles and a mix of materials, including brickwork on some upper levels. The sky is visible through the glass and between the building's sections.

1 PLAN FRAMEWORK

Overarching Goals

Planning and Design Framework

1

**Integrate
Campus with
the City**

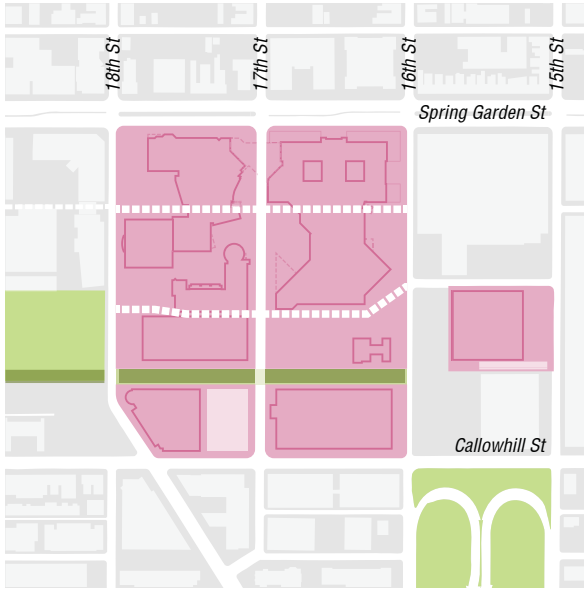

3

**Improve Learning
Environments**

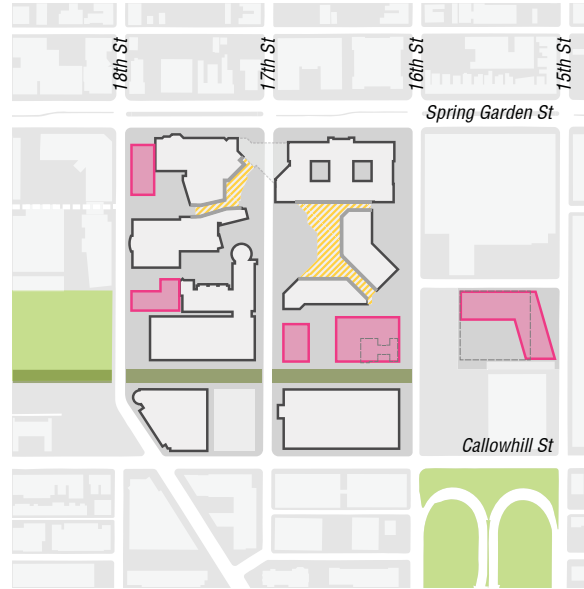

2

**Create World
Class Facilities**

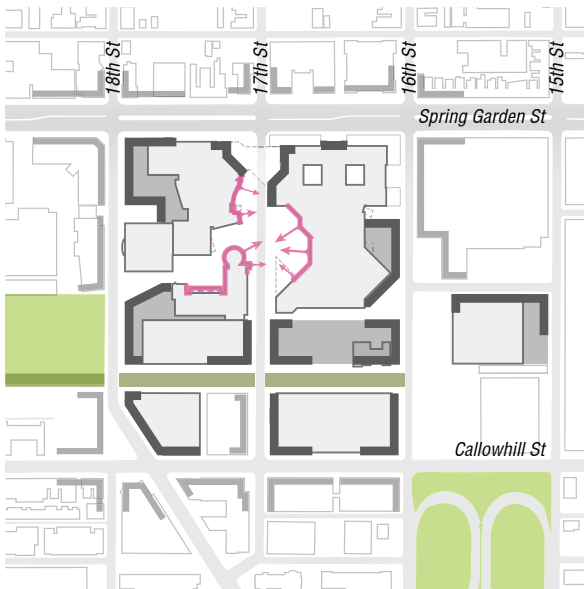

4

**Renew and Open
the Core Campus**

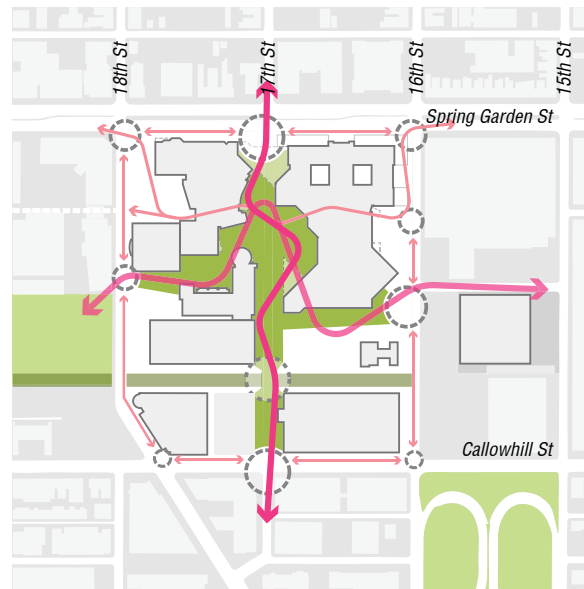

Campus Framework

Master Plan Goals, Pillars & Guided Pathways

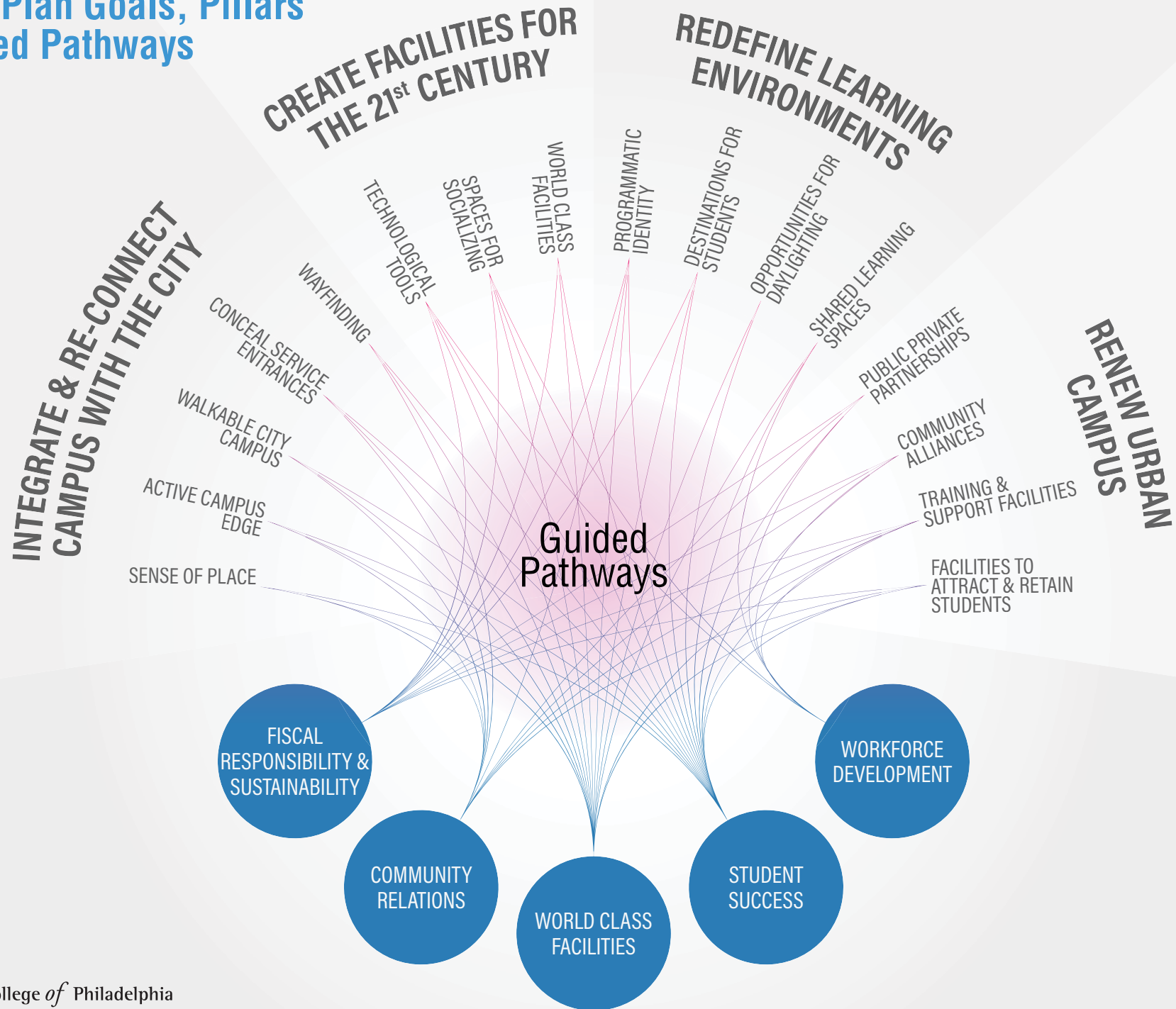

Campus Framework

Master Plan Components

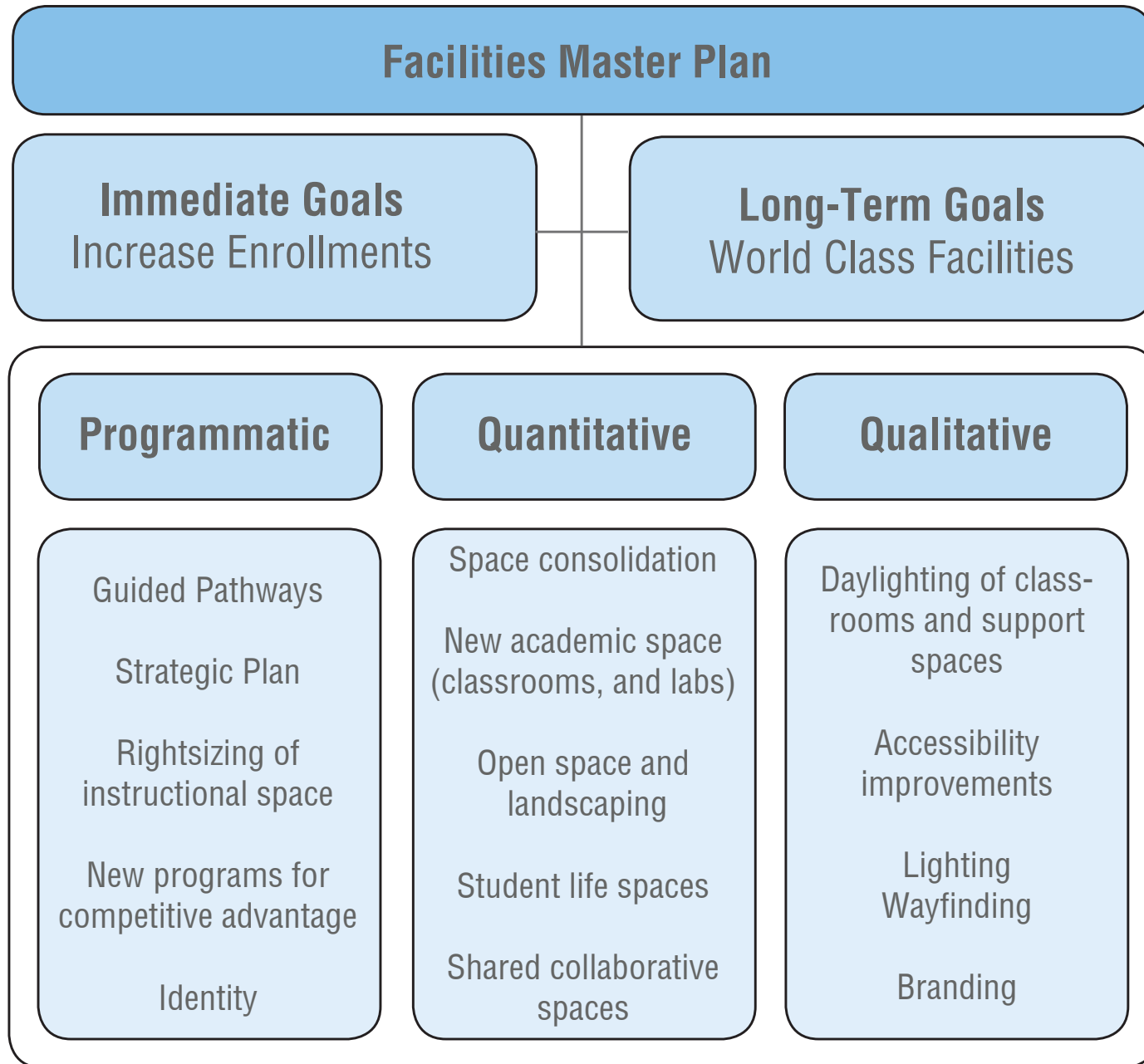

2 PROGRAMMING SUMMARY



Programming Summary

Main Campus Order of Magnitude ASF to Gross SF Space Need*

How to balance current and future enrollments with current and future space need?
Main Campus & Regional Centers

CLASSROOMS, LABS & OFFICES

NCES Space Type Code	NCES Major Space Type Category	Existing ASF	Percent of Total ASF	Proposed Need ASF	Surplus / (Deficit) Need	ASF to GSF Ratio	Total Need GSF
100	Classrooms	65,800	19.1%	69,850	(4,050)	1.5	(6,075)
110	Support and Other	13,345	3.9%	13,345	0	1.5	0
201/215	Specialized Classrms	68,290	19.8%	78,066	(9,776)	1.7	(16,619)
220	Open Laboratory	21,189	6.1%	32,057	(10,868)	1.7	(18,476)
210	Other (210 TBD)	12,198	3.5%	12,198	0	1.7	0
300	Office and Support	164,409	47.6%	170,000	(5,591)	1.6	(8,946)
Sub-total		345,231	100.0%	375,516	(30,285)	1.62	(50,115)

50,115 gsf

ENROLLMENT GROWTH & IMPACT

- Rickes & Associates reviewed the 5 year weighted average/straight-line/ and 2% growth.
- The impact was minimal and space needs were within the margin of error.

MAIN CAMPUS

- 115,000 ASF or approx. 162,000 GSF current space need based on Fall 2015 enrollments (8,664 FTE).

LIBRARY & LEARNING COMMONS

400	Library and Study	42,895	100.0%	49,123	(6,228)	1.6	(9,965)
Sub-total		42,895	100.0%	49,123	(6,228)	1.60	(9,965)

9,965 gsf

NERC

- Classrooms can be re-purposed as labs based on demand. Additional spaces may be needed for a "campus"

ATHLETICS, ASSEMBLY & SUPPORT SPACES

520	Athletics	31,720	22.6%	96,940	(65,220)	1.3	(84,786)
530	Media	6,723	4.8%	6,931	(208)	1.7	(354)
610	Assembly	7,220	5.1%	14,000	(6,780)	1.3	(8,814)
620	Exhibition	1,950	1.4%	2,500	(550)	1.3	(715)
630	Food	15,092	10.8%	15,092	0	1.3	0
650	Lounge	22,051	15.7%	22,051	0	1.3	0
660	Merchandising	7,591	5.4%	7,591	0	1.3	0
670	Recreation	1,007	0.7%	4,334	(3,327)	1.3	(4,325)
680/685	Meeting Space	13,008	9.3%	15,000	(1,992)	1.3	(2,590)
700	Support / Central Services	34,000	24.2%	34,000	0	1.3	0
Sub-total		140,362	100.0%	218,439	(78,077)	1.34	(101,583)

101,583 gsf

NWRC

- Northwest space need is more "qualitative"
- Room for additional enrollment growth

WRC

- Non Auto-tech Program - Existing Space is Available
- Transportation Technology and Logistics Center Programmatic Need (27,000 ASF)

TOTAL

Total	528,488	100.0%	643,078	(114,590)	1.52	(161,664)
--------------	----------------	---------------	----------------	------------------	-------------	------------------

161,664 gsf

*Order of magnitude space need study prepared by **Rickes and Associates** based on Fall 2015 Enrollment Numbers

A long, bright school hallway with large windows on the left and doors on the right. The hallway is empty, with a polished floor reflecting the light from the windows. The ceiling has recessed lighting and a ventilation unit. The text "MASTER PLAN RECOMMENDATIONS 3" is overlaid in blue on the right side of the image.

MASTER PLAN RECOMMENDATIONS 3

Renovations

Existing Typical Learning Environments

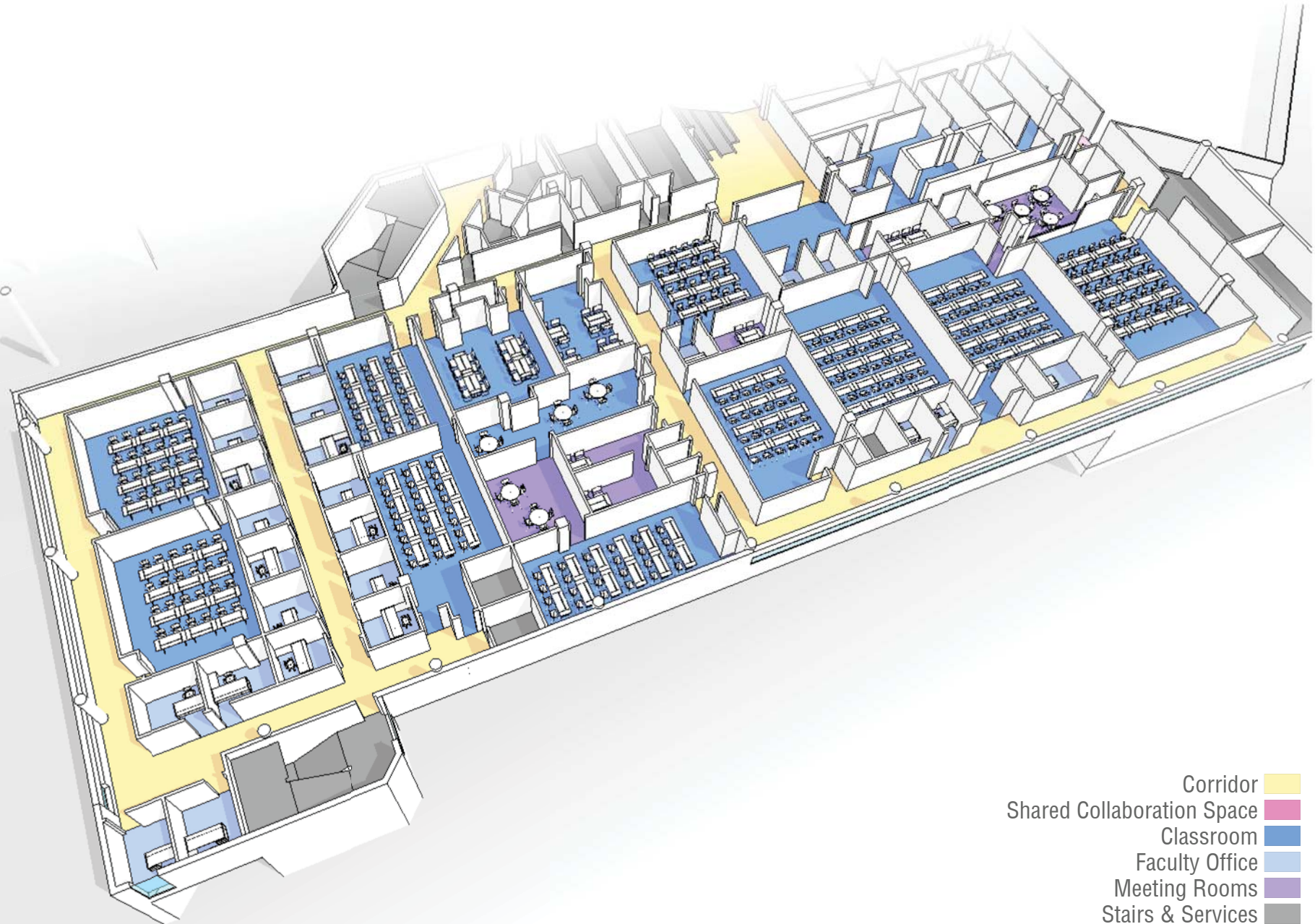

Renovations

Proposed Typical Learning Environment Upgrades

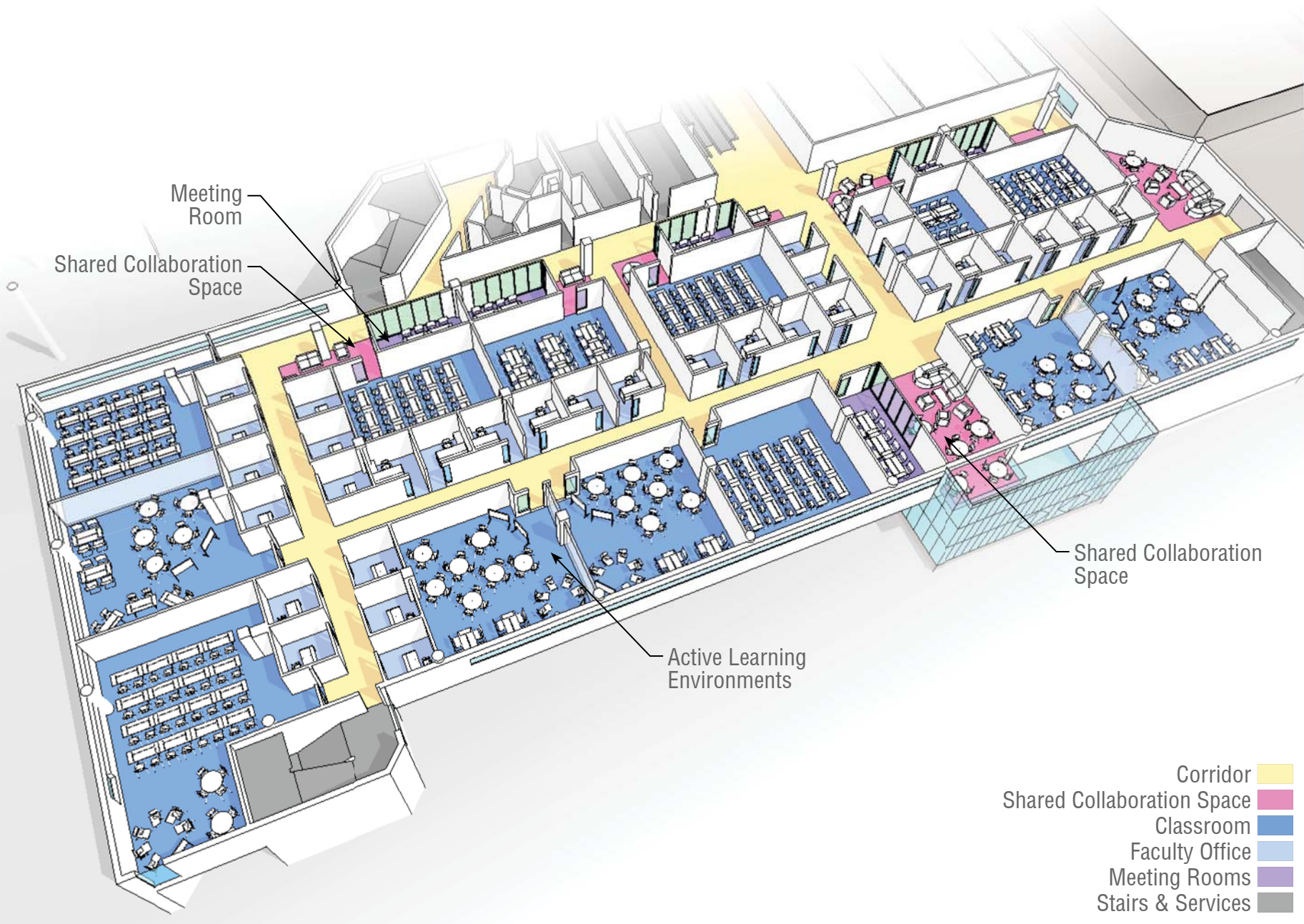

Renovations

Existing Library - Floor 01

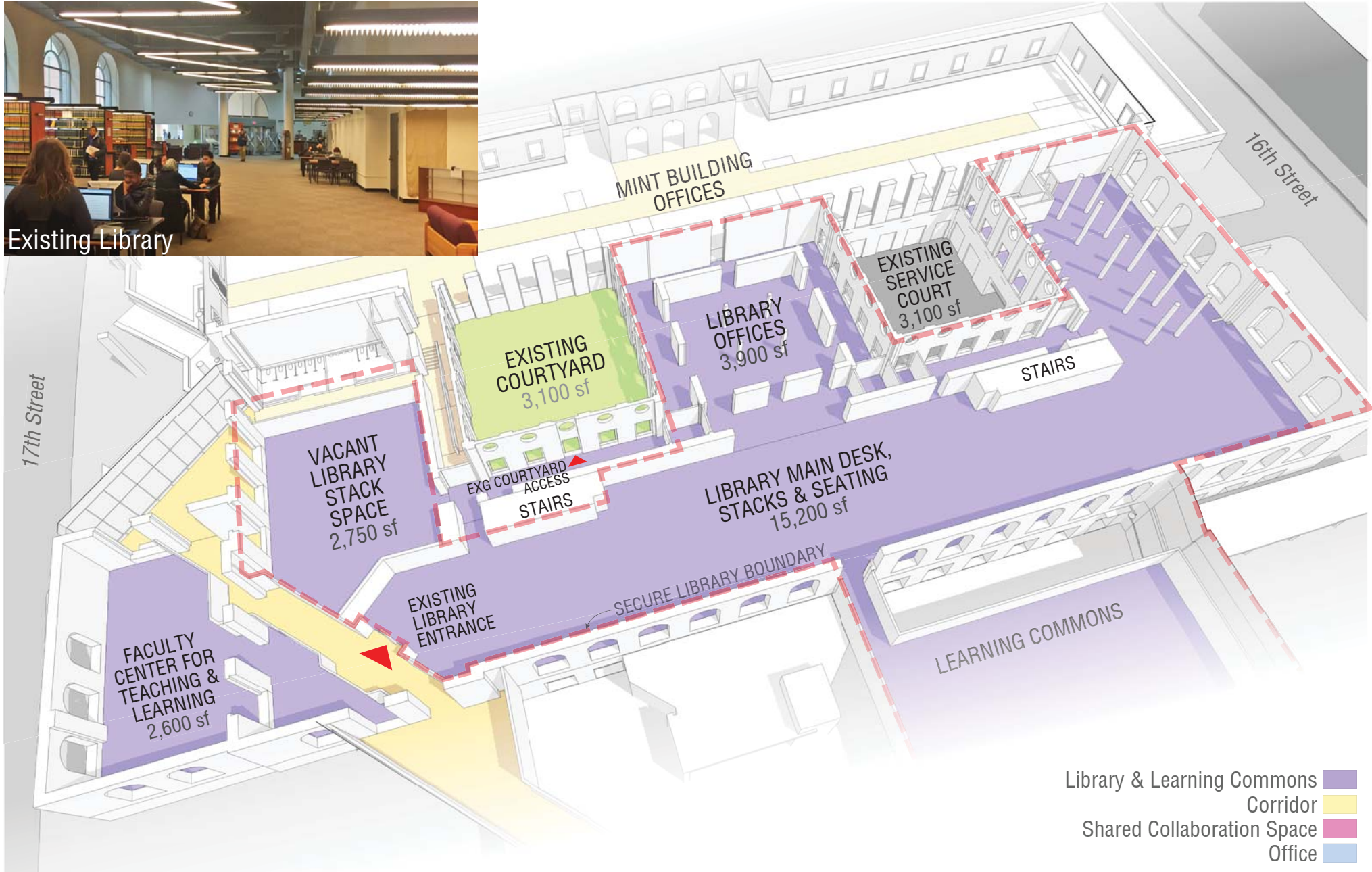

Proposed Library - Floor 01

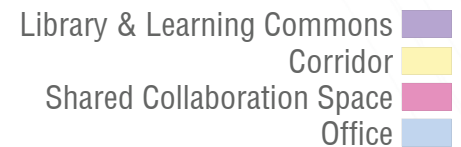

Renovations

Existing Library - Rotunda

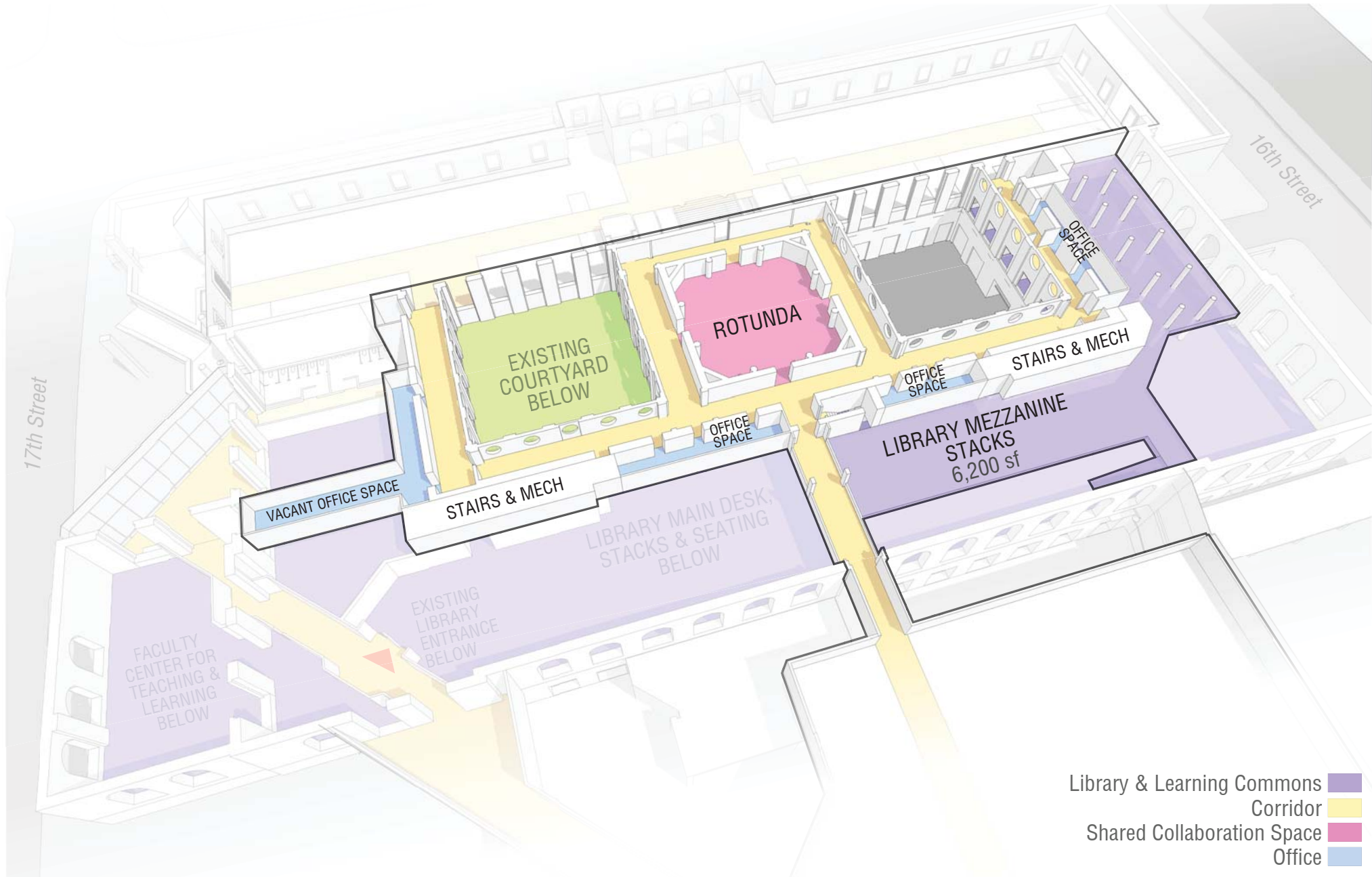

Renovations

Proposed Library - Rotunda Level Expanded Mezzanine

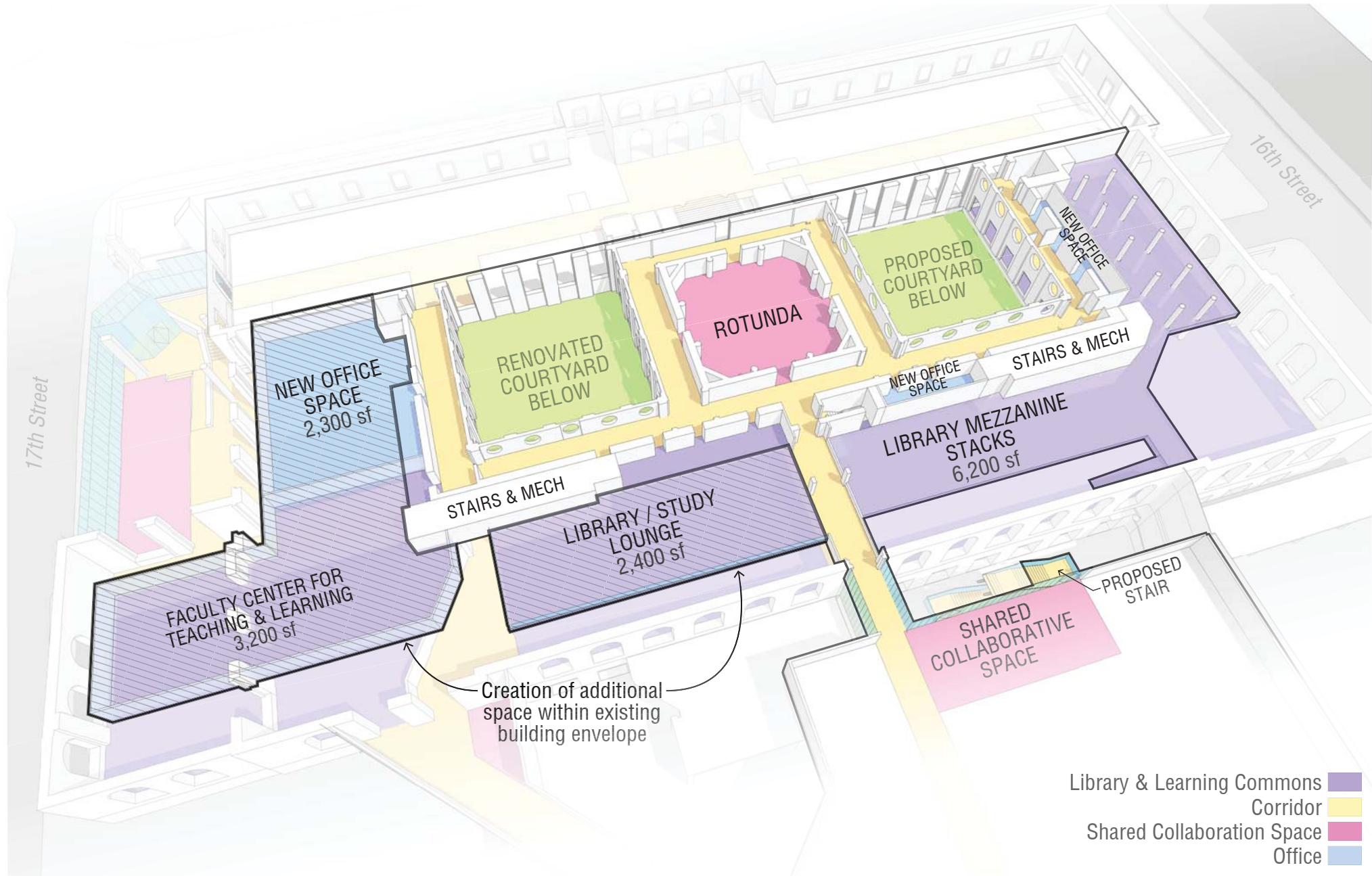

Renovations

Proposed Access to Library at Bonnell Lobby



Existing Lobby at Bonnell Building

Existing Campus Plan

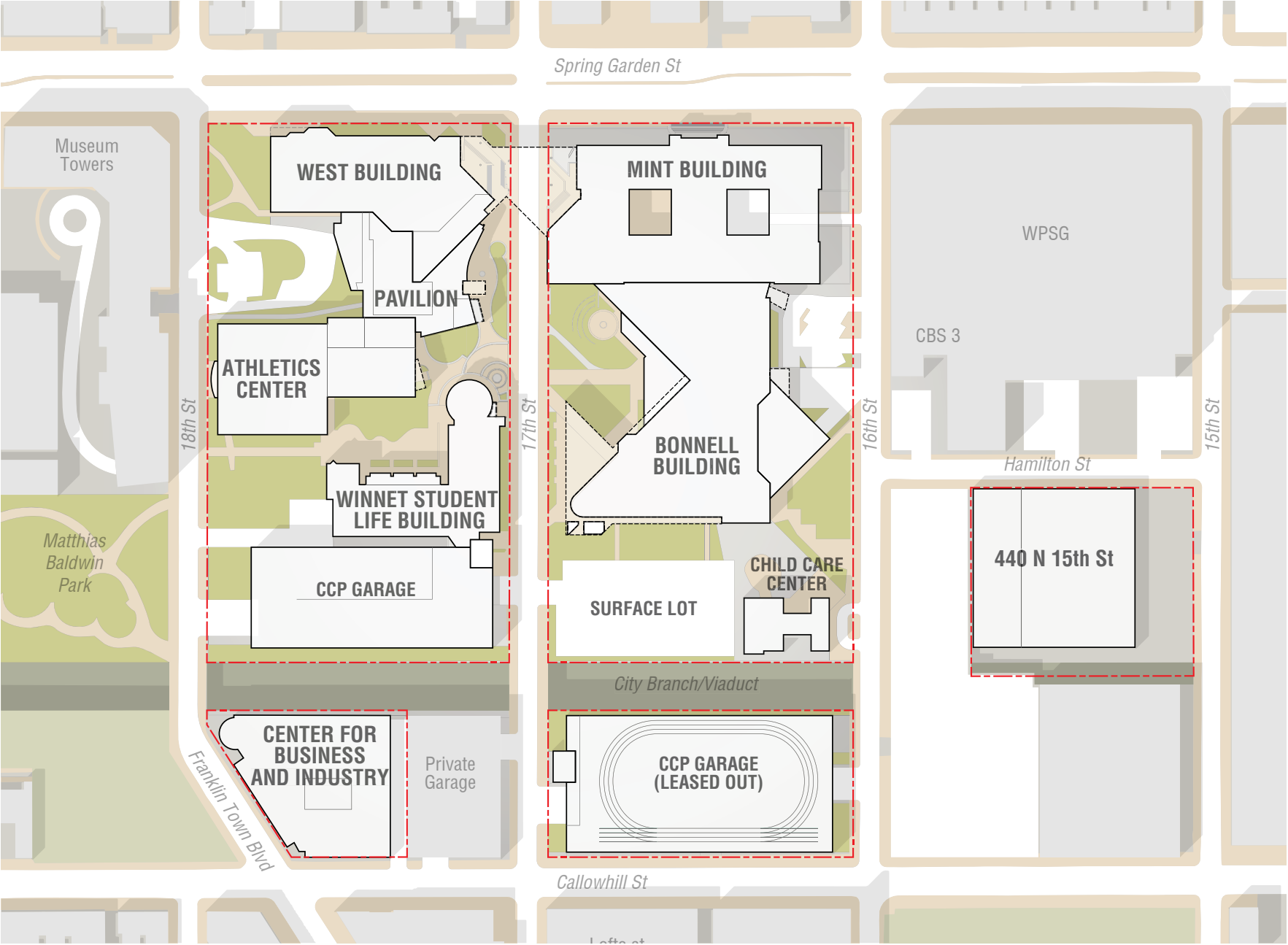

Master Plan Recommendations

Proposed Campus Master Plan

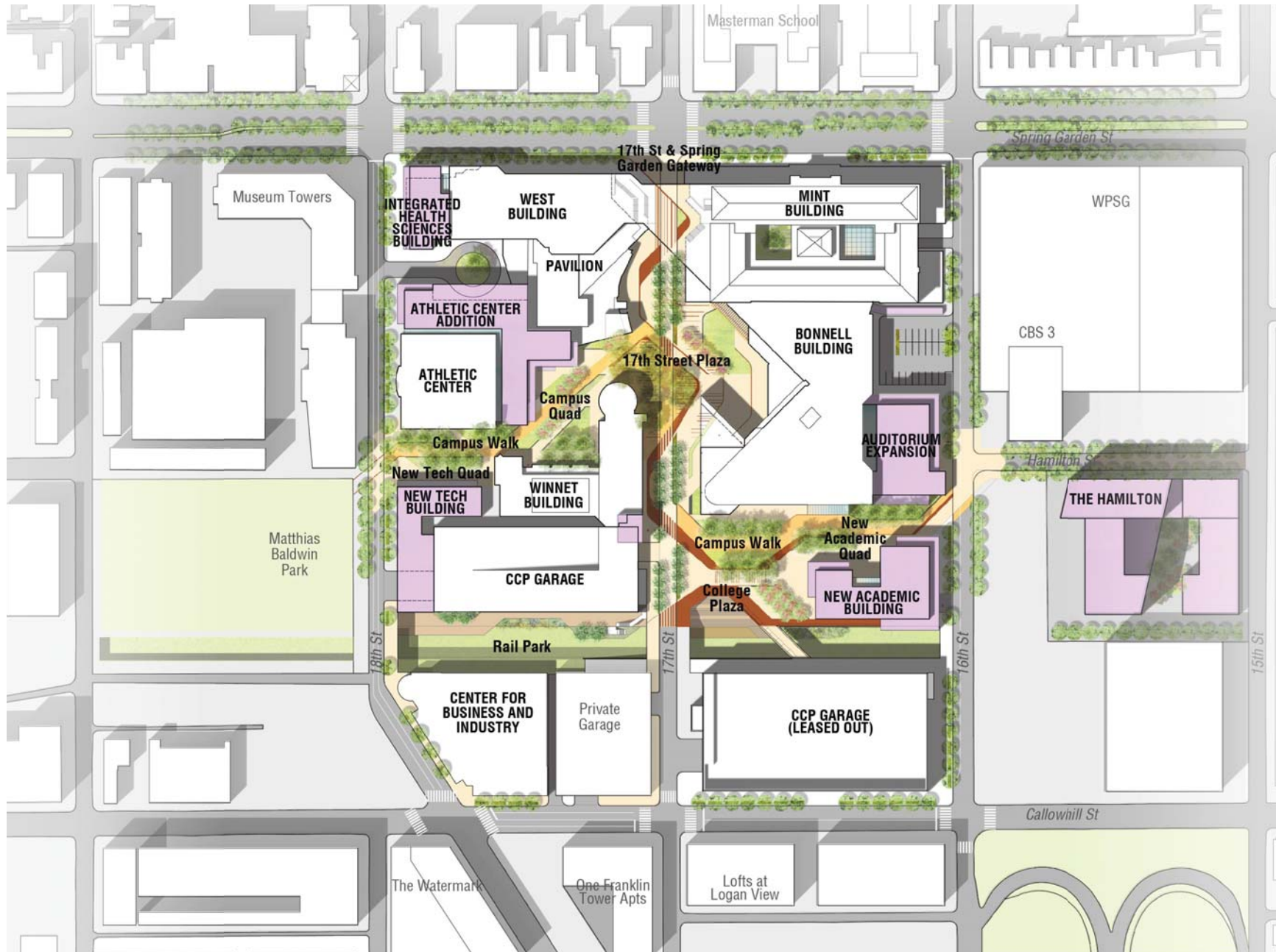

New Buildings & Additions

Existing Athletic Center & Winnet Courtyard



New Buildings & Additions

Proposed Athletic Center Addition & Renovation: 90,000 gsf

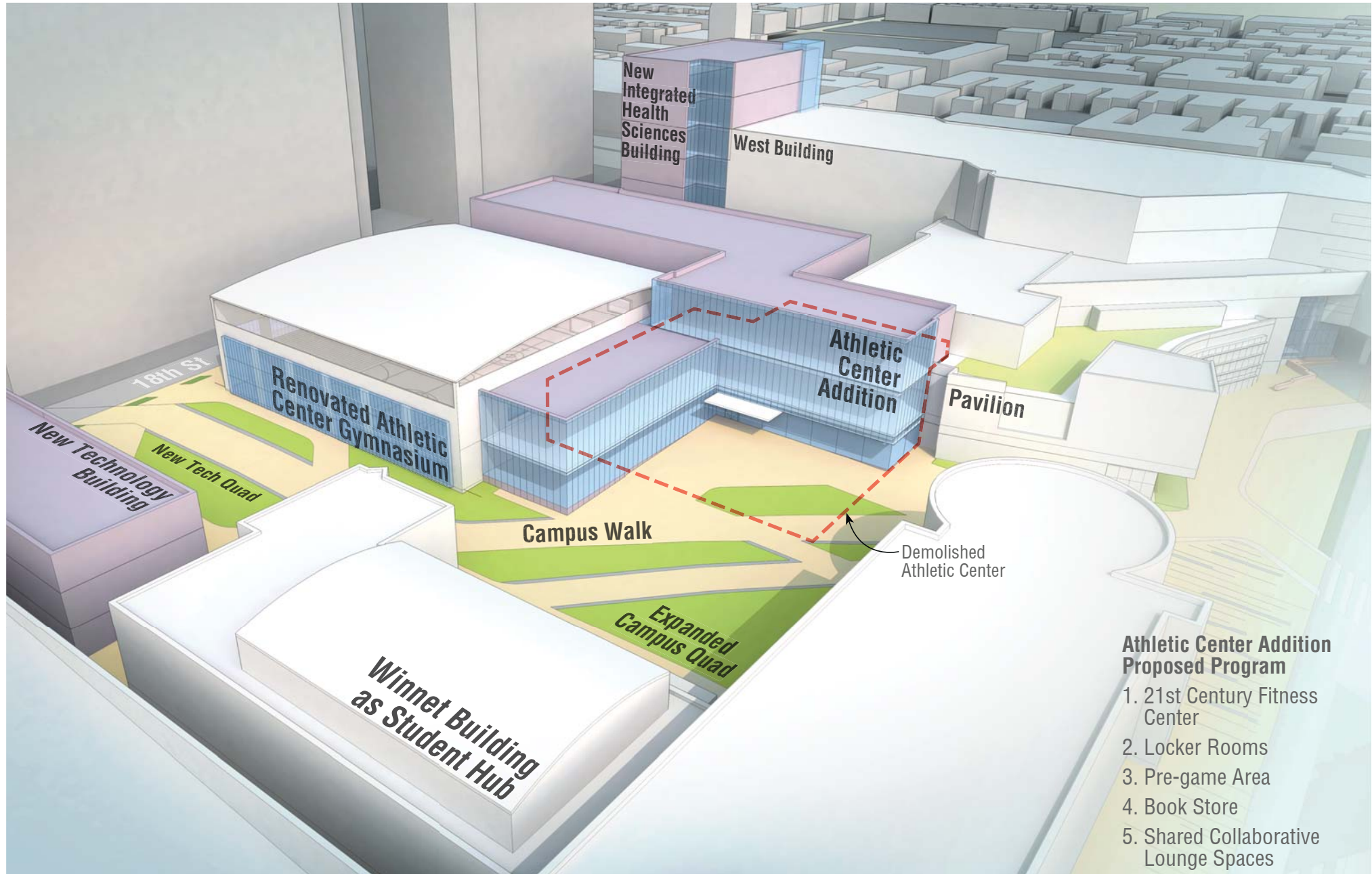

New Buildings & Additions

Existing Athletic Center at 18th & Spring Garden Street



New Buildings & Additions

Proposed Integrated Health Sciences Building & Athletic Center Addition: 18th & Spring Garden Street

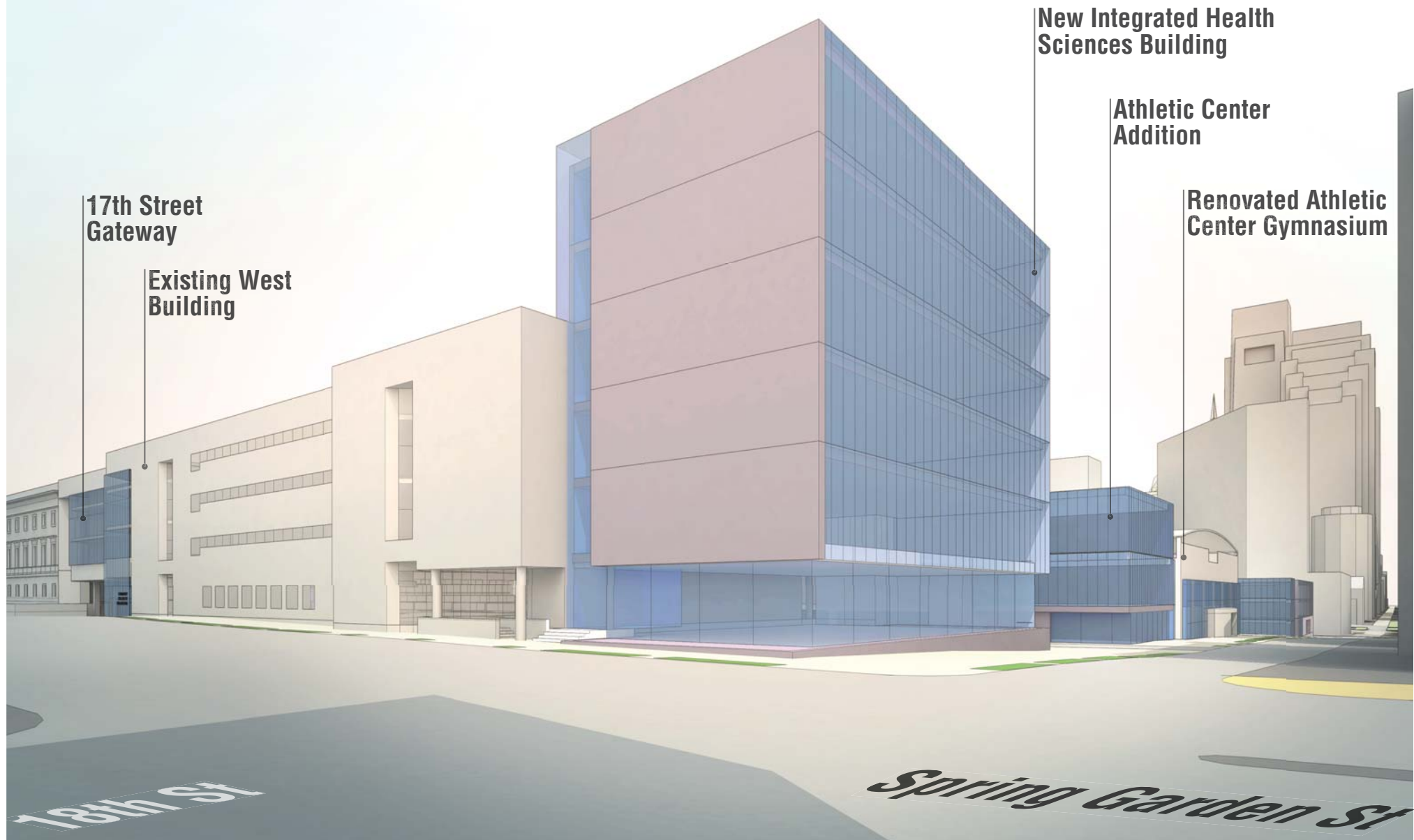

New Buildings & Additions

Existing Athletic Center along 18th Street



New Buildings & Additions

Proposed Athletic Center Renovation & Tech Building Along 18th Street

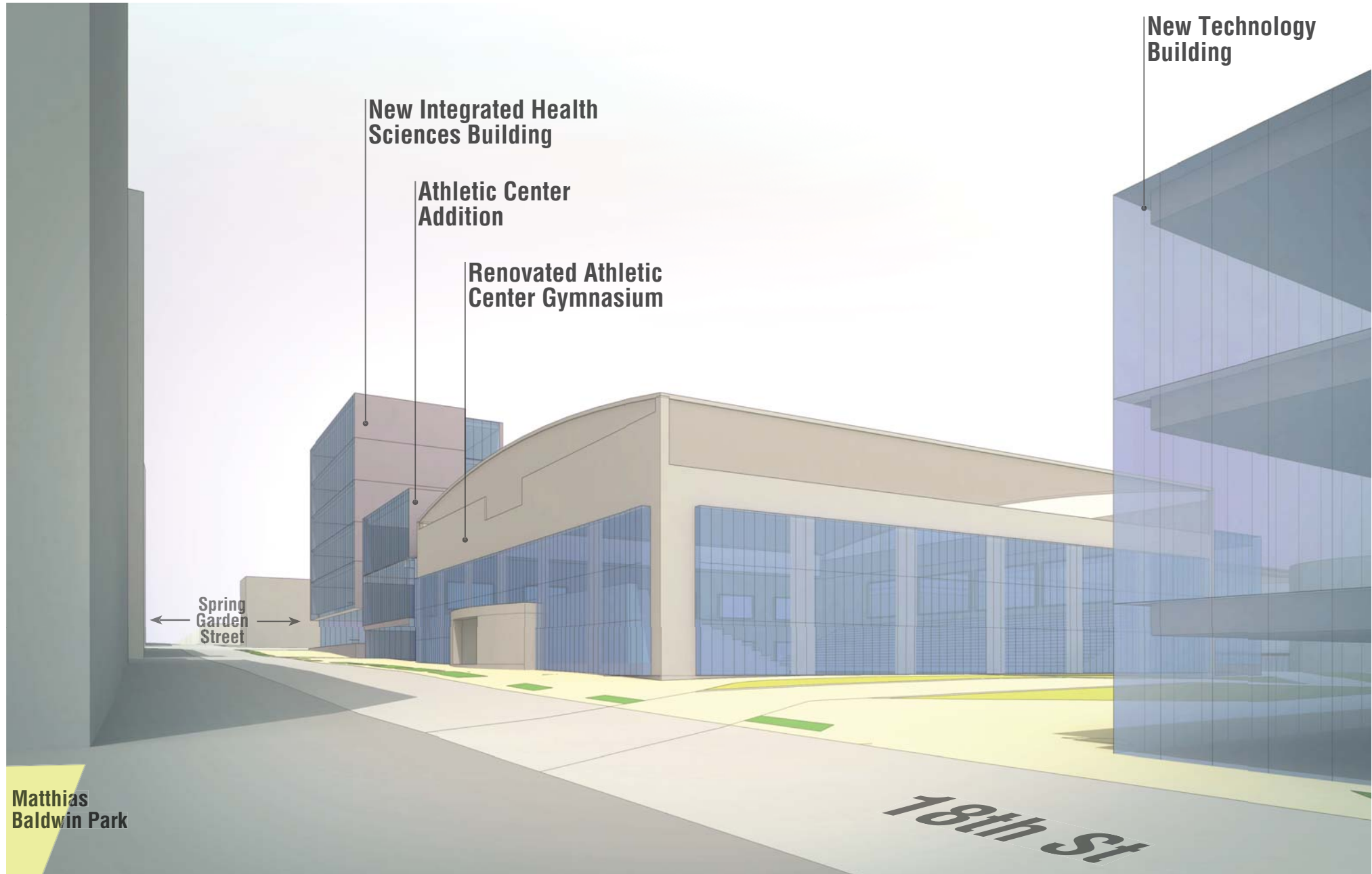

New Buildings & Additions

Proposed 17th & Spring Garden Street Gateway

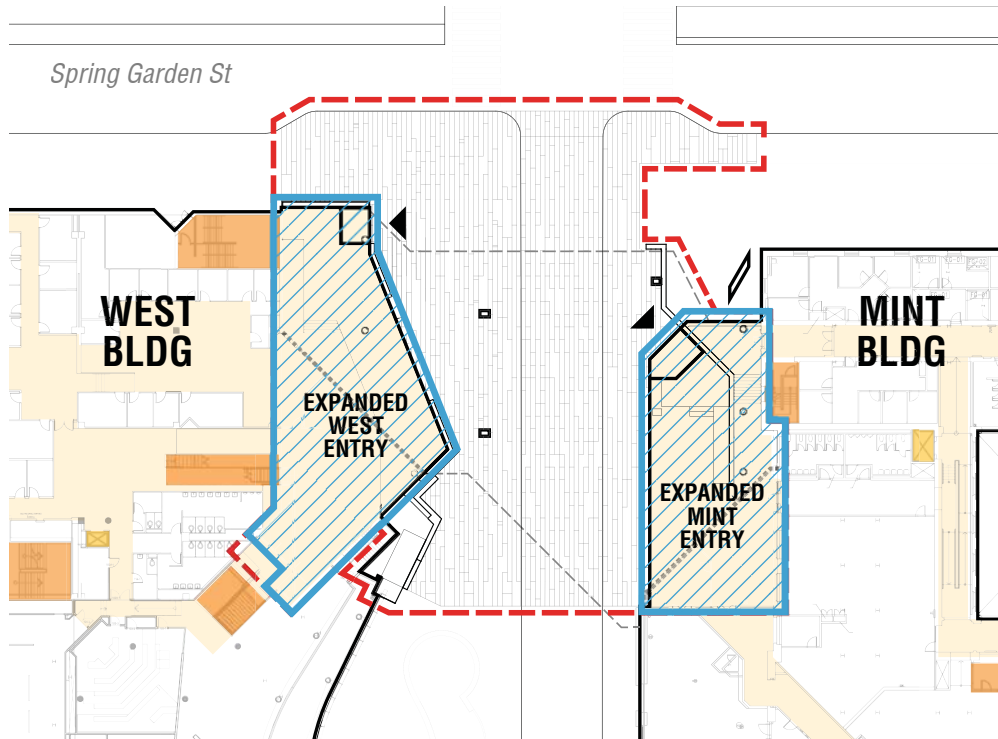

Floor 01
Expanded Entrances at 17th & Spring Garden Streets

Legend

Circulation

Vertical Circulation



New Buildings & Additions

Existing South Bonnell Building & 17th Street Parking Lot



New Buildings & Additions

Proposed Academic Building: 80,000 gsf

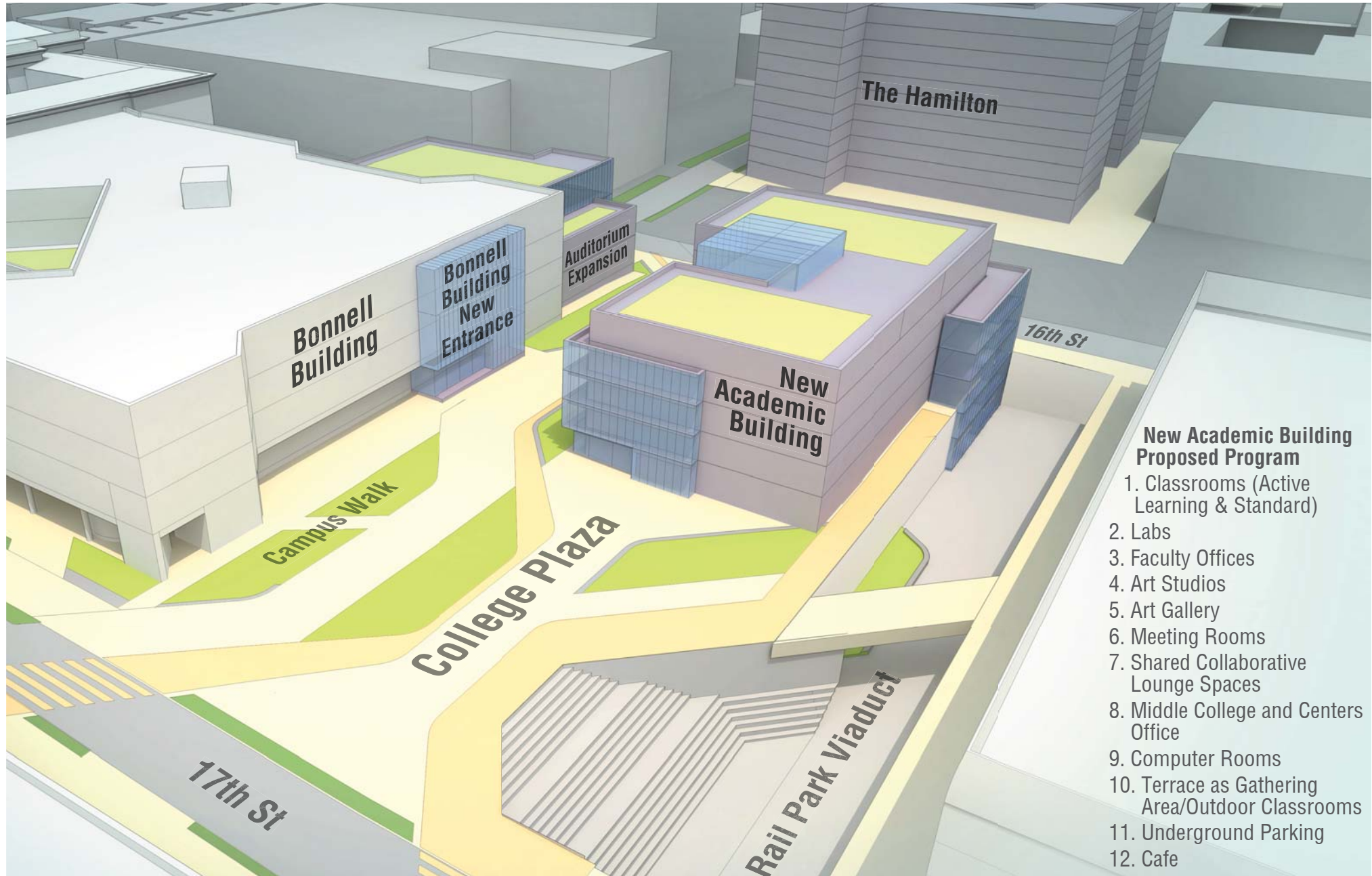

New Buildings & Additions

Existing Auditorium at Hamilton & 16th Streets



New Buildings & Additions

Proposed Auditorium: 27,000 gsf & Academic Building: 80,000 gsf



PHASING 4



Phasing

Phase I (0 - 5 yrs)

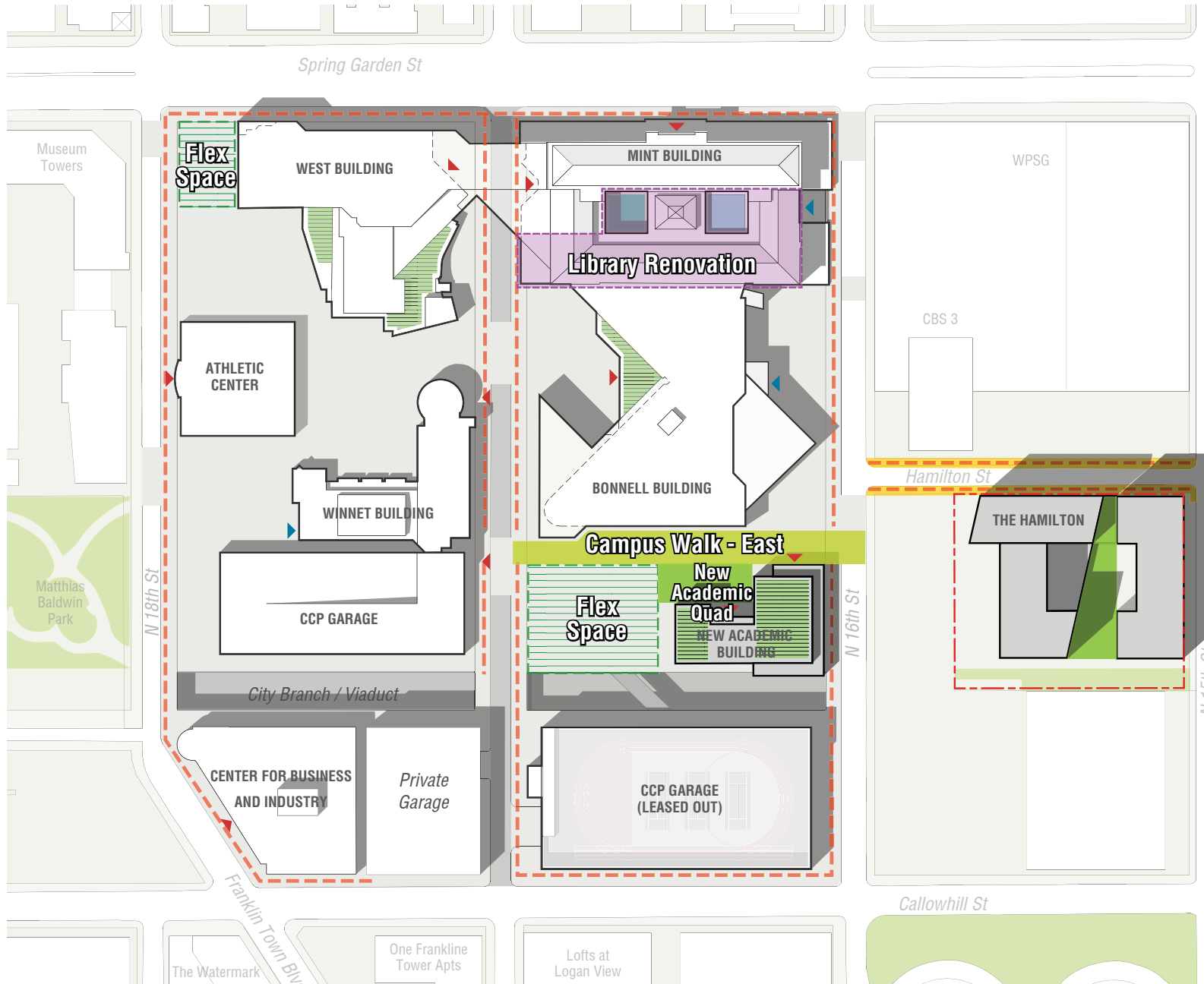

Phase I Projects

1. Library Renovation & Learning Commons
2. New Academic Building
3. The Hamilton & Hamilton Street Streetscape

Phasing

Phase II (5 - 10 yrs)

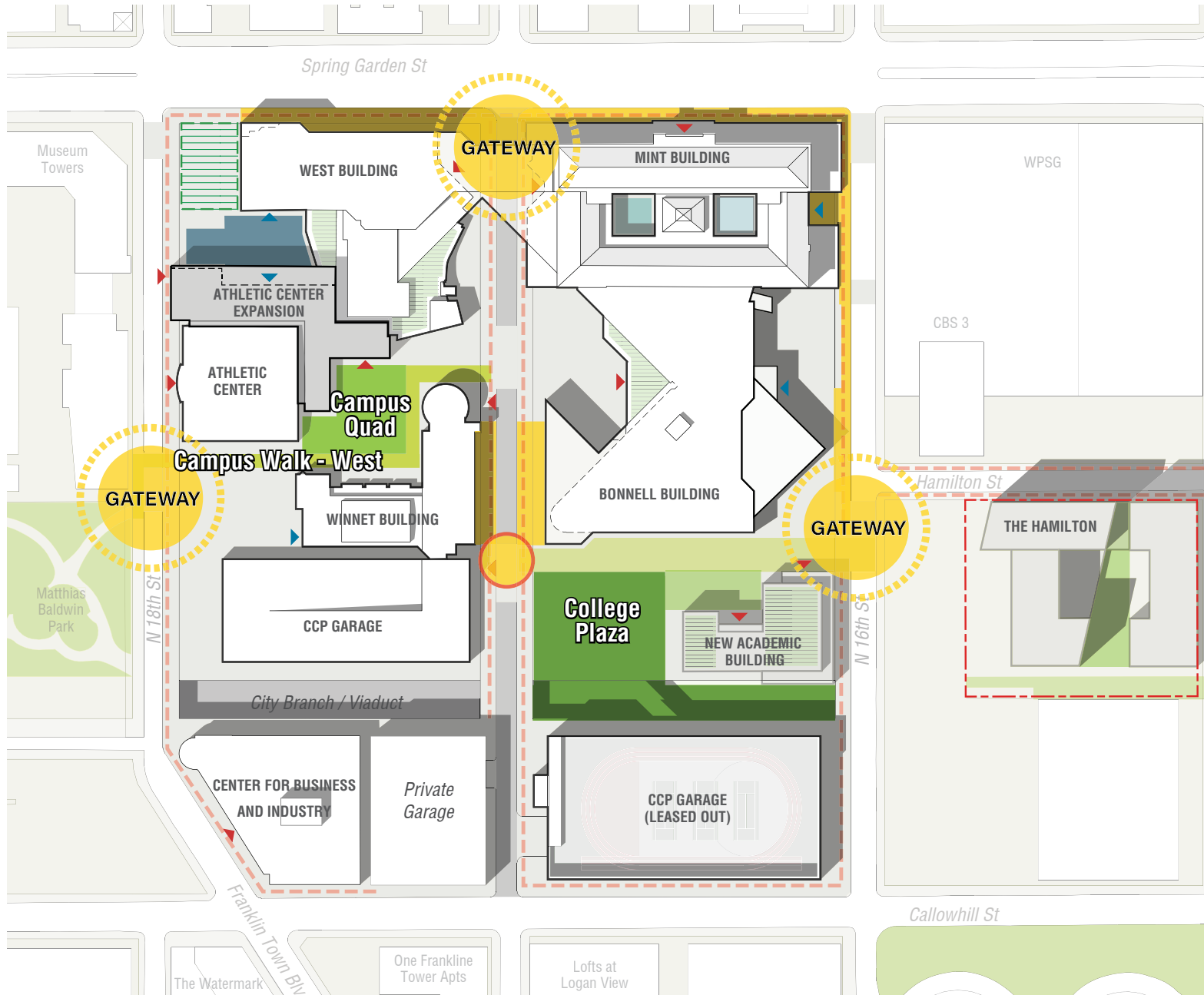

Phase II Projects

1. Gymnasium Renovation, Fitness Center Demolition & New Athletic Center
2. Main Campus Quad Expansion
3. Bonnell Ground Floor Circulation Improvements
4. Bonnell Classroom Renovations Floor 1 & 2
5. 17th & Spring Garden Mint Gateway Improvements
6. Art Studios Mint Building Retrofits
7. Mint Building 3rd Floor Office Consolidation (1500 Spring Garden Lease)
8. Winnet Student Hub Renovations



Phasing

Phase III (10 - 15 yrs)

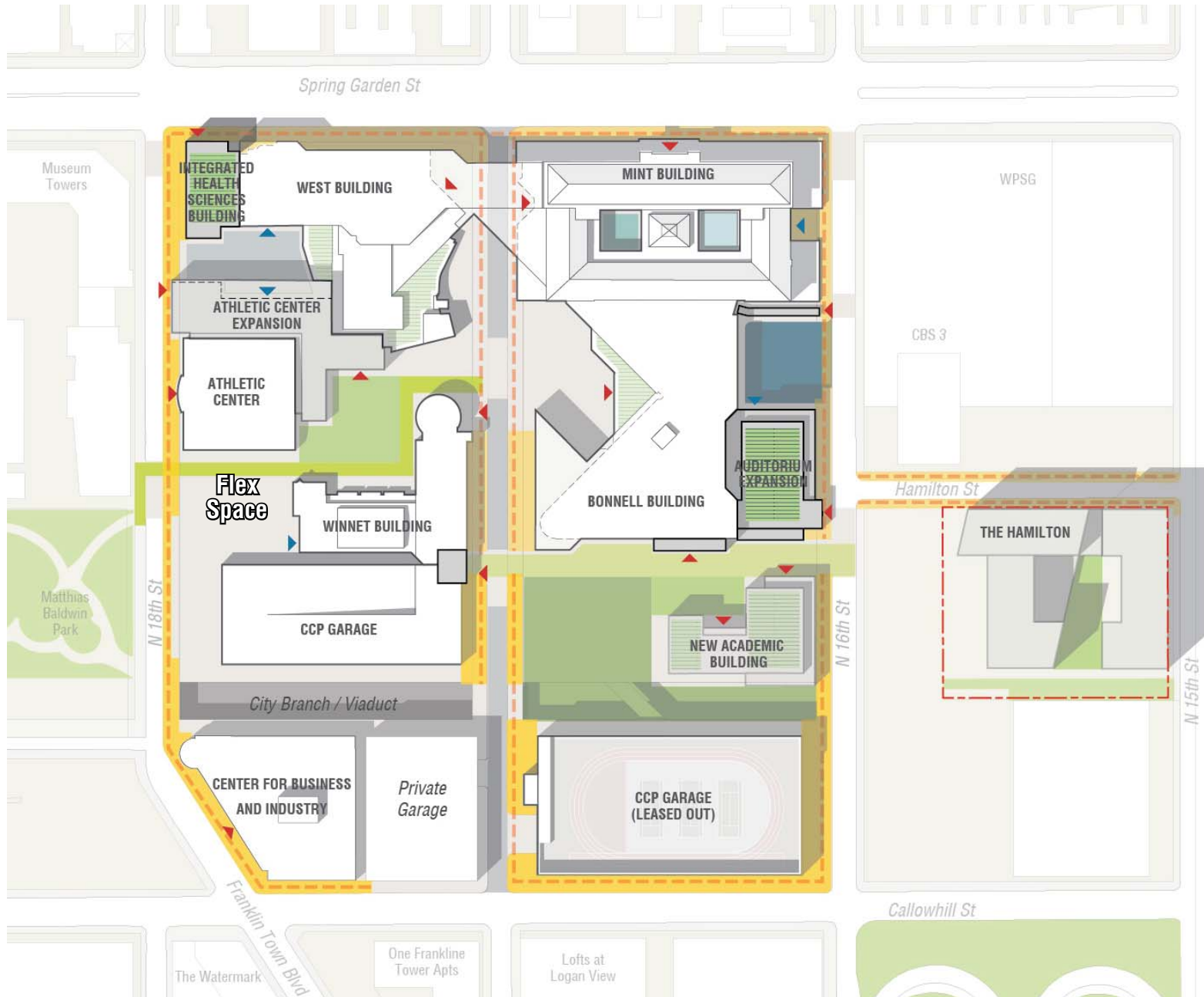

Phase III Projects

1. Auditorium Expansion
2. New Academic / Integrated Health Sciences Building (18th & Spring Garden)
3. Bonnell Classroom Renovations Floor 3

Phasing

Future (15 - 20 yrs)

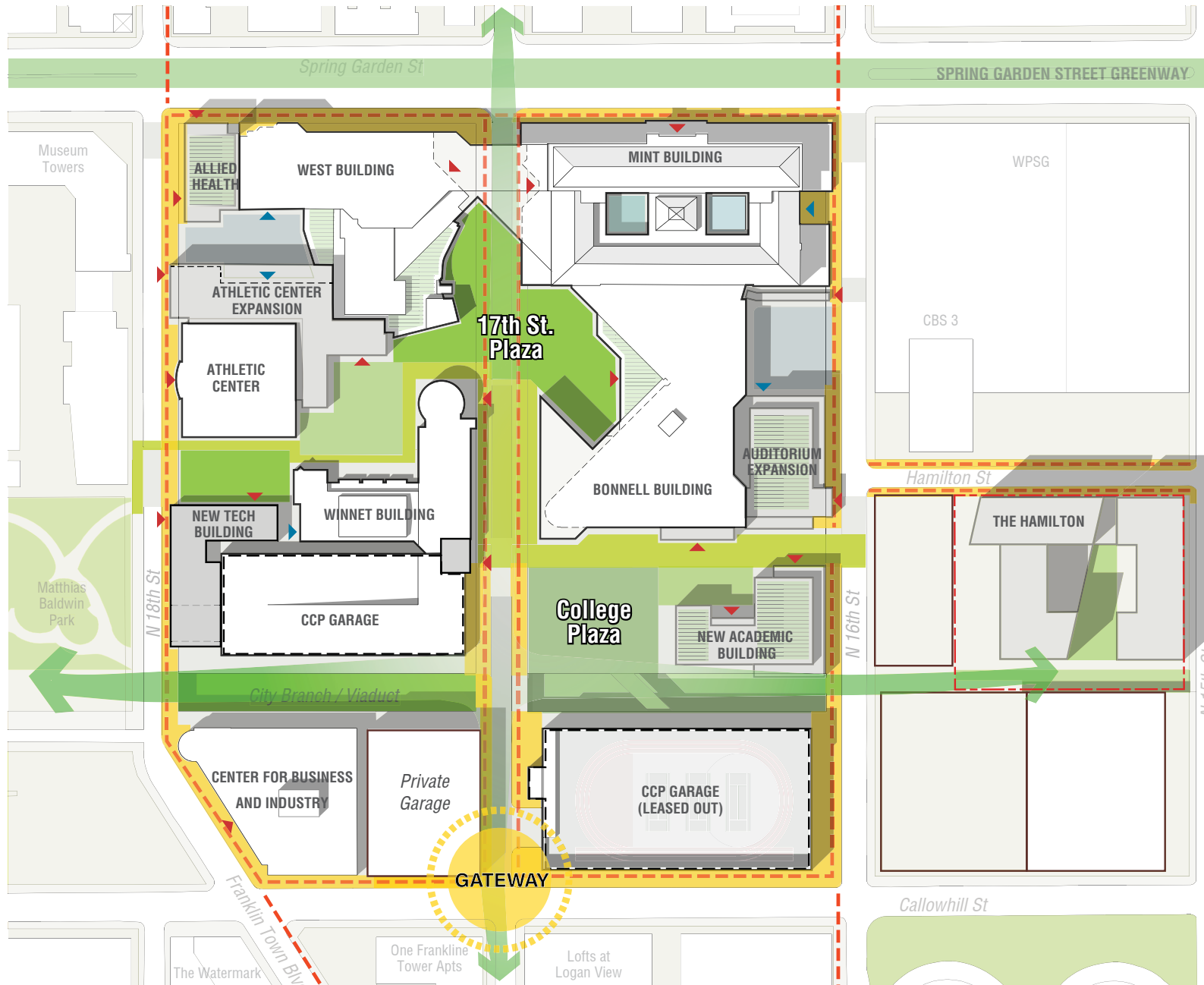

Phase IV Projects

1. New Tech. Building

- Gateways
- Building Entrance
- Service Entrance
- Environmental Graphics
- Future Purchases
- Future Developments
- Streetscape Improvements
- Community Green
- Campus Quads
- Campus Walk
- Green Roof
- Court Yard Renovation
- Loading Docks
- New Buildings



REGIONAL CENTERS 5

Northwest Regional Center

Qualitative Improvements

Vacant 3rd Floor

Need for shared spaces

Separation of Bio / Chem Lab

Additional space for Library and

Learning Commons

Administration Space

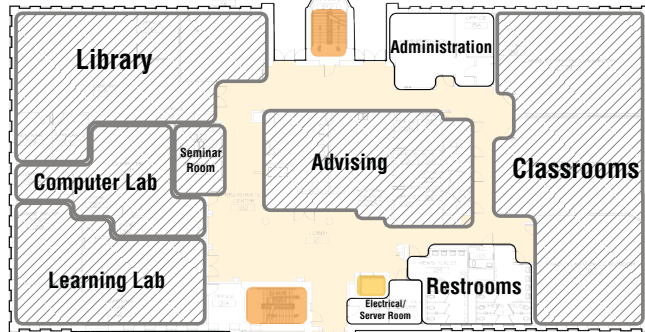

Existing North Building Floor Plan
Ground Floor

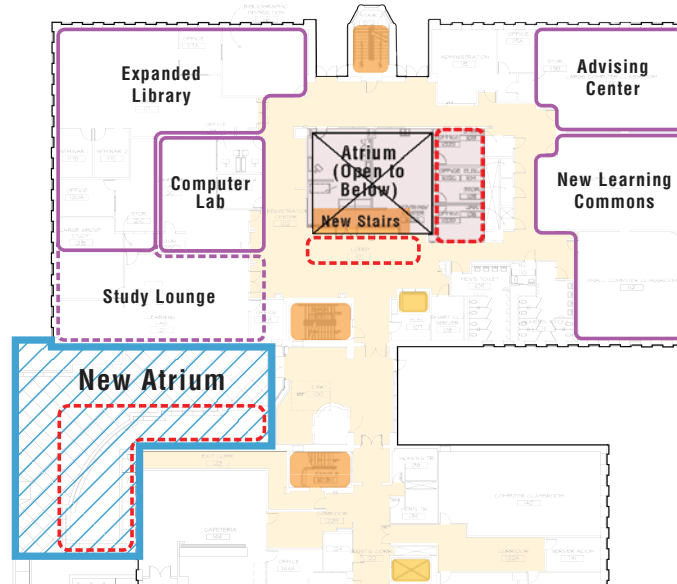

Alternative Plan
Ground Floor

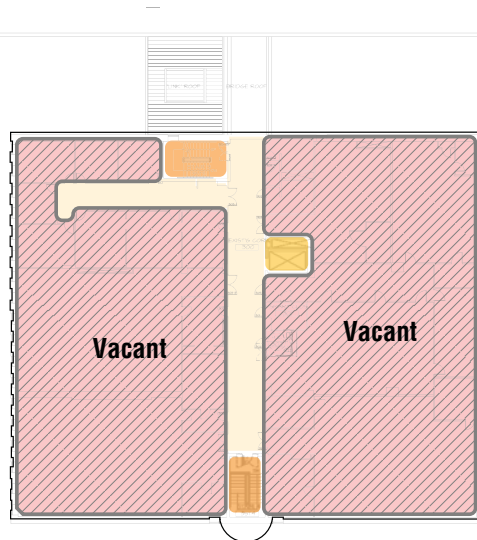

Existing South Building Floor Plan
Floor 03

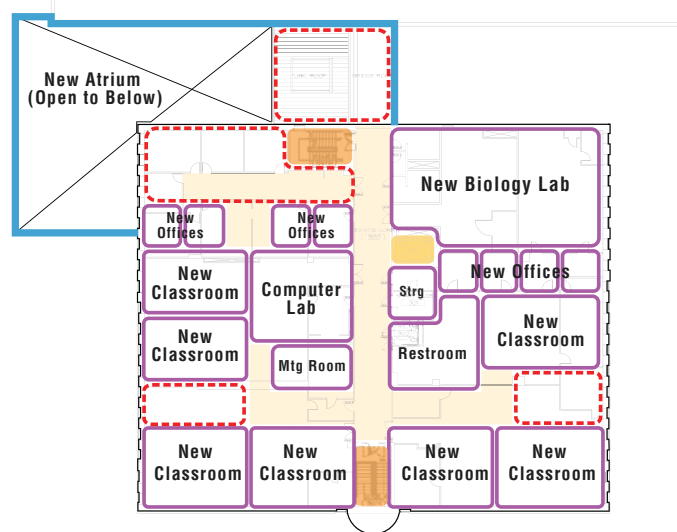

Alternative Plan
Floor 03

50' 25' 0' 5'

Legend

Circulation

Elevators

Stairs

Demolition

Vacant

New Construction

Shared Collaboration Spaces

Underutilized Spaces



Master Plan Recommendations

Existing Campus Aerial Perspective View

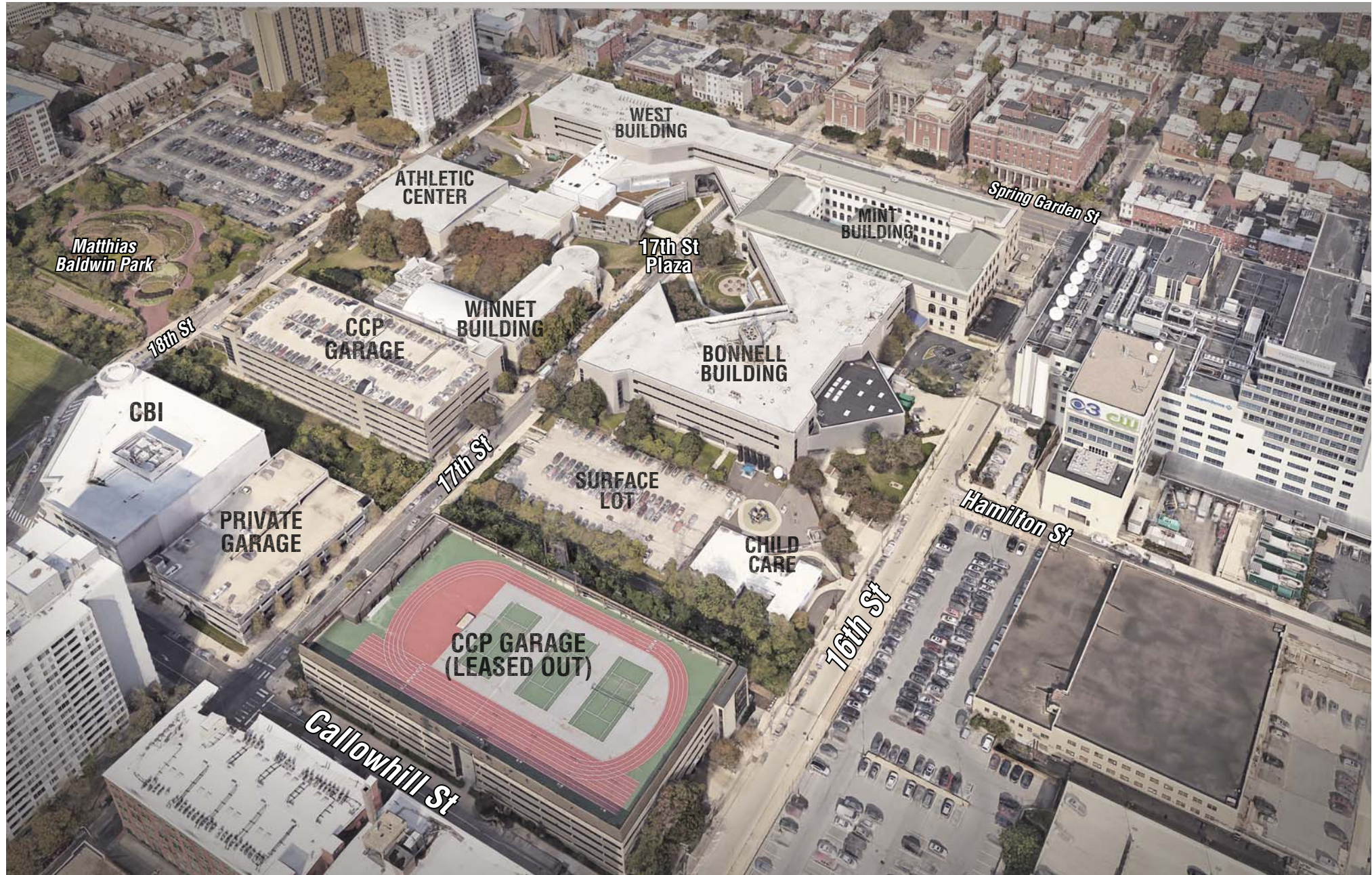

Master Plan Recommendations

Proposed Master Plan Aerial Perspective View

